

Tipperary County Council Compulsory Purchase Order

Lands proposed to be Compulsory Acquired by Tipperary County Council shown



Outlined in RED

No.26,27,28 & 29 Morton St, Clonmel, Co. Tipperary

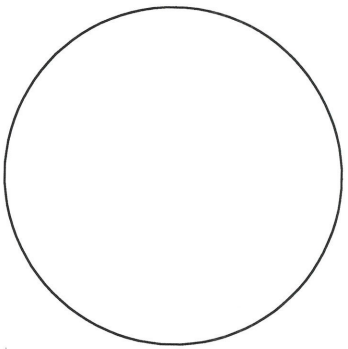
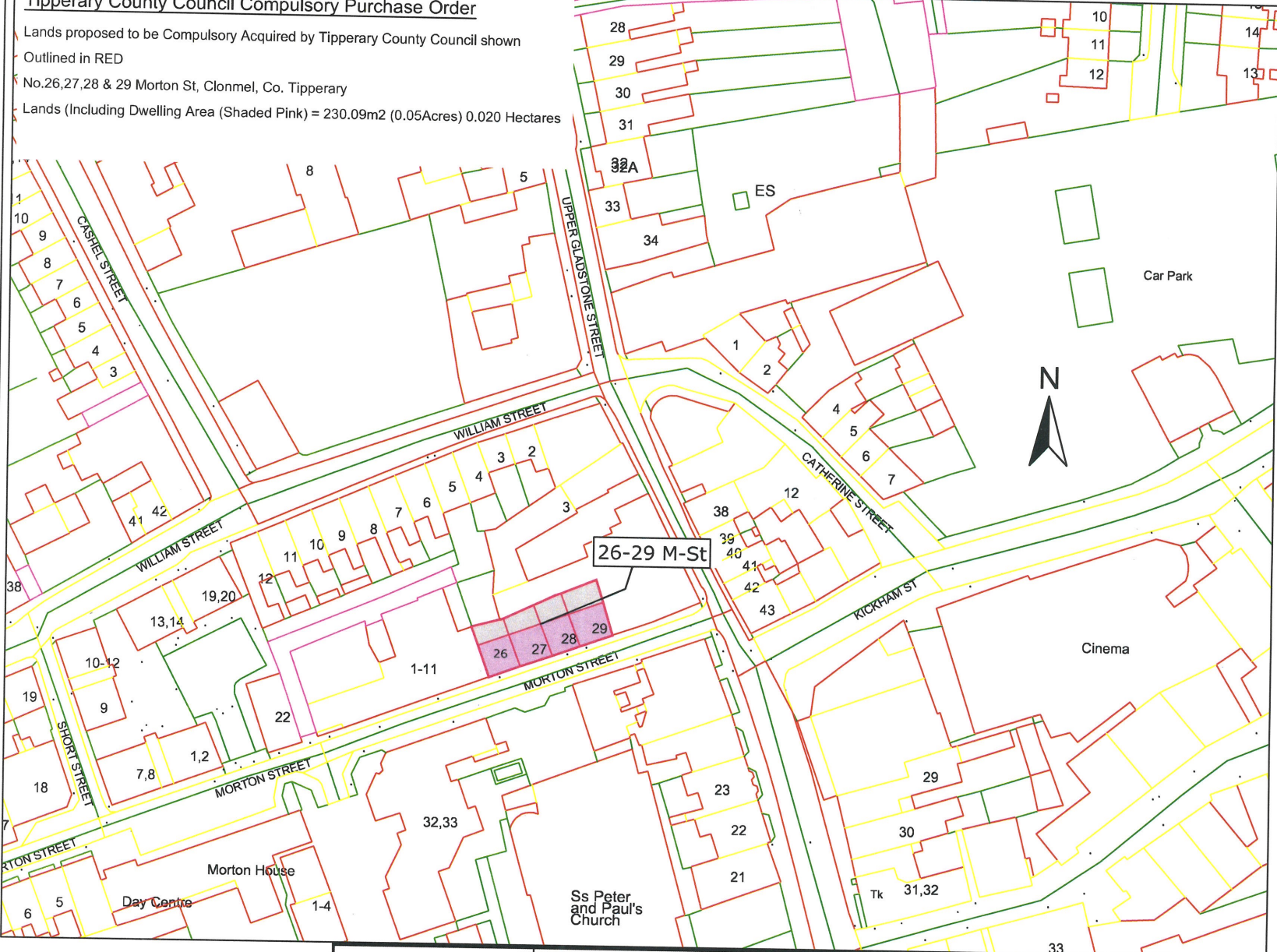
Lands (Including Dwelling Area (Shaded Pink) = 230.09m² (0.05Acres) 0.020 Hectares

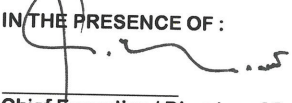

THE OFFICIAL SEAL OF
 TIPPERARY COUNTY COUNCIL
 WAS AFFIXED HERETO
 THIS 14th DAY OF July 2023

IN THE PRESENCE OF:

 Chief Executive / Director of Services

 Cathaoirleach

Description/Schedule:
 A) 26,27,28 & 29 Morton St, Clonmel
 Area 0.020Ha 0.050Acres

Map Notes:
 Lands delineated by the centre of the
 thin red line

Townland : Clonmel
 O.S.Ref No: 5430-11

ITM Coordinates used

© Ordnance Survey Ireland.
 All rights reserved.
 Licence number:
 2023/10/CCMA/TipperaryCountyCouncil.

Drawn By: S.SMYTH	Checked By:
Date: 22th June 2023	Dwg No: 2023-CPO-02
Scale: 1:1000 @ A4	

Title:
CPO - 26-29 Morton St, Clonmel
Deposited Map 2023
File No. 2023-CPO-02

