

Fire Resistance EN 1365 (series)

Ability to withstand or contain a fire and still function -

R - mechanical resistance i.e. an ability to maintain loadbearing capacity,

E - integrity i.e. an ability to maintain the integrity of the structure,

I - insulation i.e. an ability to provide insulation from high temperatures

Reaction to Fire I.S.EN 13501-1

Materials contribution to a fire -

All products, excluding floorings, are classified as A1, A2, B, C, D, E or F (with class A1 being the highest performance and F being the lowest) e.g.;

A1 - it does not fuel or contribute to the fire

F - indeterminate behavior, materials and products untested



TFRS

Consolidated Guidance on Fire Safety Provisions to Dwelling House Types

Incorporating guidance from:
Technical Guidance Document B (Fire Safety) Volume 2 Dwelling Houses 2017
and
Supplementary Guidance to TGD B (Fire Safety) Volume 2 - Dwelling Houses

Notes:

This diagrammatic guidance document has been put together to assist owners, builders and designers with regards to fire safety provisions in the 5 most common dwelling house types:

Bungalow - Page 2

Dormer Bungalow - Page 3

Two Storey - Page 4

Dormer Two Storey - Page 5

Three Storey - Page 6

The guidance within this document is not exhaustive, reference should be made to *Technical Guidance Document B (Fire Safety) Volume 2-Dwelling Houses 2017* and the *Supplementary Guidance to TGD B (Fire Safety) Volume 2 - Dwelling Houses 2017*, to ensure full compliance with Part B of the Building Regulations.

Responsibility for ensuring full compliance with the Building Regulations remains with the Owner, Builder and Designer of the works. You are advised to review your design to ensure compliance with all Parts of the Building Regulations.

For Modern Methods of Construction refer to Manufacturer's Test Data and Agrément Certification to ensure compliance with Part B of Building Regulations.

Rev 1 - November 2022

Queries or comments should be referred to fireoff@tipperarycoco.ie

Common Non-Compliances Found during Building Control Inspections of Dwellings with Regards to Part B:

- | | |
|--|------------------------------------|
| 1. Installation of smoke alarms in all habitable rooms | (TGD B 2017 - Section 1.3.6) |
| 2. Use of optical smoke detectors on ground floor | (TGD B 2017 - Section 1.3.6.3) |
| 3. Correct location of detectors from other features (300mm) | (TGD B 2017 - Section 1.3.6.3) |
| 4. Height of escape windows / rooflights | (TGD B 2017 - Section 1.3.7.1) |
| 5. Fire stopping at top of party walls (max. gap of 50mm) | (TGD B 2017 - Diagram 10) |
| 6. Spacing of screw fixings to plasterboard in framed construction | (refer to manufacturers test data) |
| 7. Fire resistance provisions to upper floors | (refer to manufacturers test data) |
| 8. Fire stopping to openings in floors with open voids (metal web) | (refer to manufacturers test data) |
| 9. Fitment of cavity barriers | (TGD B 2017 - Section 3.6.3) |
| 10. Provision of simple fastenings to final exits (thumb latches) | (TGD B 2017 - Section 1.3.9.7) |
| 11. Fitment of fire doors (hinges, seals, self closer) | (refer to manufacturers test data) |
| 12. Isolation switch for PV arrays | (TGD B 2017 - Section 5.4.5.1) |

The above list is not exhaustive, reference should be made to *Technical Guidance Document B (Fire Safety) Volume 2-Dwelling Houses 2017* and the *Supplementary Guidance to TGD B (Fire Safety) Volume 2 - Dwelling Houses 2017*, to ensure full compliance with Part B of the Building Regulations.

While every care has been taken in the preparation of this guidance document, Tipperary County Council assume no responsibility for and give no guarantees, undertakings or warranties concerning the accuracy, completeness or up to date nature of the information provided and does not accept liability whatsoever arising from any errors or omissions. Please notify any errors, omissions and comments by email to fireoff@tipperarycoco.ie.

Fire Resistance EN 1365 (series)

R - mechanical resistance i.e. an ability to maintain loadbearing capacity,
E - integrity i.e. an ability to maintain the integrity of the structure,
I - insulation i.e. an ability to provide insulation from high temperatures

- ■ ■ ■ ■ RE30 REI 15
(30 minutes fire resistance load bearing capacity and integrity, 15 minutes insulation)
- ■ ■ ■ ■ REI 30
(30 minutes fire resistance load bearing capacity, integrity and insulation)



Truss:

No fire resistance required to truss if it only supports the roof, **unless** used as a means of escape or is essential for the stability of an external wall. (refer to Section 3.4.4 of TGD B Vol. 2 2017)

Where truss requires fire resistance refer to *Supplementary Guidance on Fire Resistance of Trussed Roofs* (truss types achieve REI 30)

External Walls

(Table A1 TGD B Vol.2 2017):

<1m to Boundary: REI 30
>1m to Boundary: RE 30, REI 15

Where external walls are timber frame - refer to: *Supplementary Guidance on Fire Resistance of Walls* (wall types achieve REI 30)

For RE30, REI15 fire resistance refer to Manufacturer's test data / Agrément certification

(Note: fire resistance provision to external walls of bungalow dependant on boundary separation)

Window for escape or rescue:

Min. clear open area: 0.33m²
Min. Height: 450mm
Min. Width: 450mm

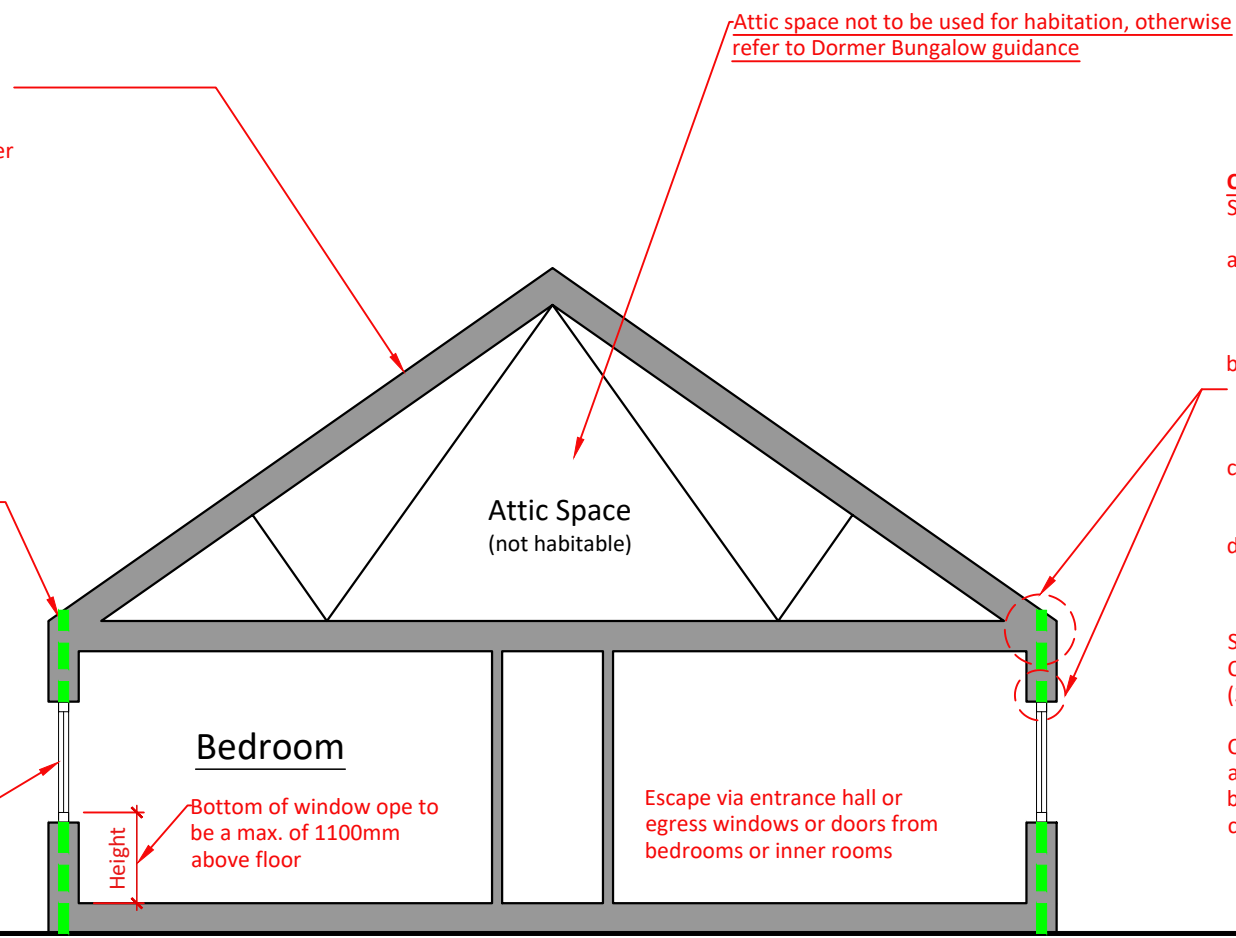

Attic space not to be used for habitation, otherwise refer to Dormer Bungalow guidance

Cavity Barriers:

Section 3.6.2 of TGD B Vol. 2 2017

- a. Top of an external cavity wall (masonry or framed construction) including any gable wall
- b. Vertically at the junction of separating wall and any such wall with an external cavity wall
- c. Above the enclosures to a protected stairway
- d. Around all openings (windows, doors, vents, service boxes etc) in framed construction

Section 3.6.3 of TGD B Vol. 2 2017
Cavity Barrier to achieve E30 EI15 fire resistance (30 minutes integrity and 15 minutes insulation)

Cavity barriers may be formed of:

- a. steel at least 0.5mm thick, or
- b. timber at least 38mm thick, or
- c. polythene sleeved mineral wool, or mineral wool slab, in either case under compression when installed in the cavity

House Type: Bungalow

Notes:

The above guidance is not exhaustive, reference should be made to *Technical Guidance Document B (Fire Safety) Volume 2-Dwelling Houses 2017* and the *Supplementary Guidance to TGD B (Fire Safety) Volume 2 - Dwelling Houses 2017*, to ensure compliance with Part B of the Building Regulations.

Responsibility for ensuring full compliance with the Building Regulations remains with the Owner, Builder and Designer of the works. You are advised to review your design to ensure compliance with all Parts of the Building Regulations.

For Modern Methods of Construction refer to Manufacturer's Test Data and Agrément Certification to ensure compliance with Part B of Building Regulations.

Rev 1 - November 2022

Queries or comments should be referred to fireoff@tipperarycoco.ie

Key Notes: (Tick off as addressed / complete)

- Final exits in accordance with Section 1.3.9.7 of TGD B Vol. 2 2017 (thumb-turn latch)
- Escape windows in accordance with Section 1.3.7 of TGD B Vol. 2 2017
- Fire detection and alarm system - LD2 or better in accordance with IS 3218
- Cavity barriers in accordance with Section 3.6.2 of TGD B Vol. 2 2017
- Fire resistance provisions in accordance with Appendix A of TGD B Vol.2 2017:
 - External walls
 - Upper floors (if applicable)
 - Roof truss (if applicable)
 - Elements supporting fire resistant construction (if applicable)

Fire Resistance EN 1365 (series)

R - mechanical resistance i.e. an ability to maintain loadbearing capacity,
E - integrity i.e. an ability to maintain the integrity of the structure,
I - insulation i.e. an ability to provide insulation from high temperatures

- - - RE30 REI 15
(30 minutes fire resistance load bearing capacity and integrity, 15 minutes insulation)
- - - REI 30
(30 minutes fire resistance load bearing capacity, integrity and insulation)



Rooflight Alternative:

1.7m max. from eaves to bottom of the opening section of the rooflight

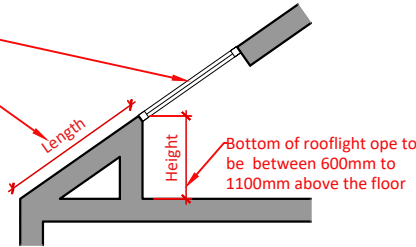

Window / rooflight for escape or rescue:

Min. clear open area: 0.33m²
Min. Height: 450mm
Min. Width: 450mm

1.7m max. from eaves to vertical plane of the window

External Walls

(Table A1 TGD B Vol.2 2017):

<1m to Boundary: REI 30
≥1m to Boundary: RE 30, REI 15

Where external walls are timber frame - refer to: *Supplementary Guidance on Fire Resistance of Walls* (wall types achieve REI 30)

For RE30, REI15 fire resistance refer to Manufacturer's test data / Agrément certification

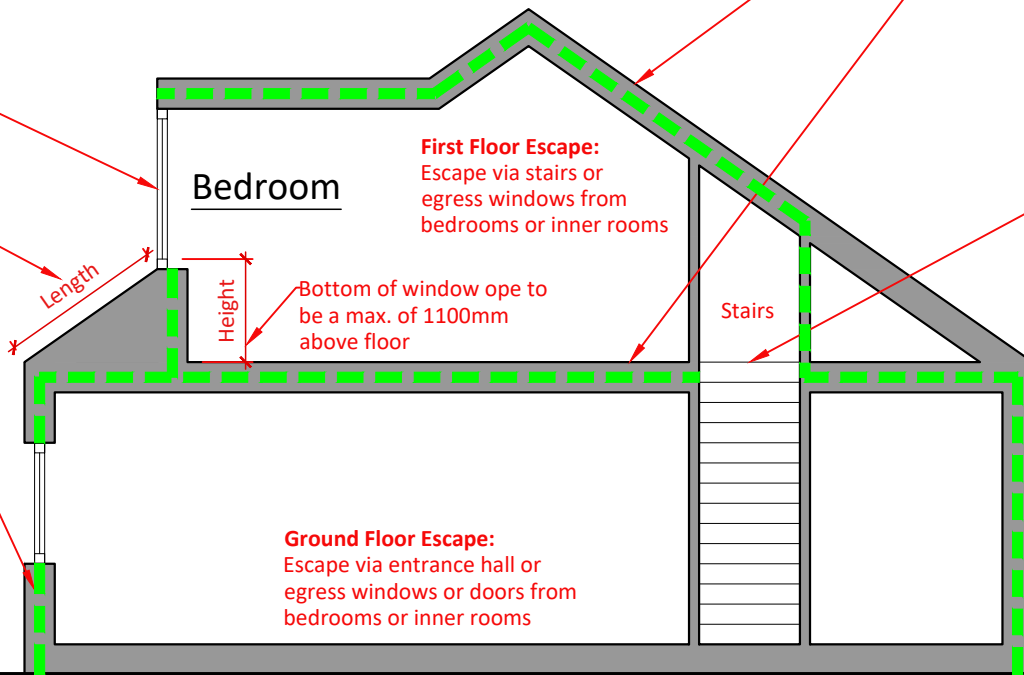

Truss:

Truss forms floor of dormer therefore it must achieve fire resistance. As per Table A1 - Item 3(a) TGD B Vol 2 2017, it should achieve RE30 REI15 (REI 30 if floor is over garage - including supporting structure)

Where truss requires fire resistance refer to *Supplementary Guidance on Fire Resistance of Trussed Roofs* (truss types achieve REI 30)

For RE30 REI15 rating refer to manufacturers test data or Agrément Certificates.

Stairs:

For stairs to dormer bungalow (2 storey) - 1st Floor ≤ 4.5m above ground level

The stairway should be enclosed with storey-height construction, which need not be fire resisting, and should discharge directly to the open air.

For open plan arrangements refer to Section 1.3.2.1 of TGD B Vol. 2 2017

Cavity Barriers

Refer to Bungalow House Type (Page 2) for information on location of cavity barriers

No floor more than 4.5m above ground level - Purpose Group 1(a)

House Type: Dormer Bungalow

Notes:

The above guidance is not exhaustive, reference should be made to *Technical Guidance Document B (Fire Safety) Volume 2-Dwelling Houses 2017* and the *Supplementary Guidance to TGD B (Fire Safety) Volume 2 - Dwelling Houses 2017*, to ensure compliance with Part B of the Building Regulations.

Responsibility for ensuring full compliance with the Building Regulations remains with the Owner, Builder and Designer of the works. You are advised to review your design to ensure compliance with all Parts of the Building Regulations.

For Modern Methods of Construction refer to Manufacturer's Test Data and Agrément Certification to ensure compliance with Part B of Building Regulations.

Rev 1 - November 2022

Queries or comments should be referred to fireoff@tipperarycoco.ie

Key Notes: (Tick off as addressed / complete)

- Final exits in accordance with Section 1.3.9.7 of TGD B Vol. 2 2017 (thumb-turn latch)
- Escape windows in accordance with Section 1.3.7 of TGD B Vol. 2 2017
- Fire detection and alarm system - LD2 or better in accordance with IS 3218
- Cavity barriers in accordance with Section 3.6.2 of TGD B Vol. 2 2017
- Fire resistance provisions in accordance with Appendix A of TGD B Vol.2 2017:
 - External walls
 - Upper floors (if applicable)
 - Roof truss (if applicable)
 - Elements supporting fire resistant construction (if applicable)

Fire Resistance EN 1365 (series)

R - mechanical resistance i.e. an ability to maintain loadbearing capacity,
E - integrity i.e. an ability to maintain the integrity of the structure,
I - insulation i.e. an ability to provide insulation from high temperatures

- RE30 REI 15
(30 minutes fire resistance load bearing capacity and integrity, 15 minutes insulation)
- REI 30
(30 minutes fire resistance load bearing capacity, integrity and insulation)



Truss:

No fire resistance required to truss if it only supports the roof, **unless** used as a means of escape or is essential for the stability of an external wall. (refer to Section 3.4.4 of TGD B Vol. 2 2017)

Where truss requires fire resistance refer to *Supplementary Guidance on Fire Resistance of Trussed Roofs* (truss types achieve REI 30)

Attic space not to be used for habitation, otherwise refer to *Dormer Two Storey* guidance

Window for escape or rescue:

Min. clear open area: 0.33m²
 Min. Height: 450mm
 Min. Width: 450mm

External Walls

(Table A1 TGD B Vol.2 2017):

<1m to Boundary: REI 30
 ≥1m to Boundary: RE 30, REI 15

As the external walls will support the upper floors of the dwelling they should achieve a fire resistance rating of RE30 REI15

Where external walls are timber frame - refer to *Supplementary Guidance on Fire Resistance of Walls* (wall types achieve REI 30)

For RE30, REI15 fire resistance refer to Manufacturer's test data / Agrément certification

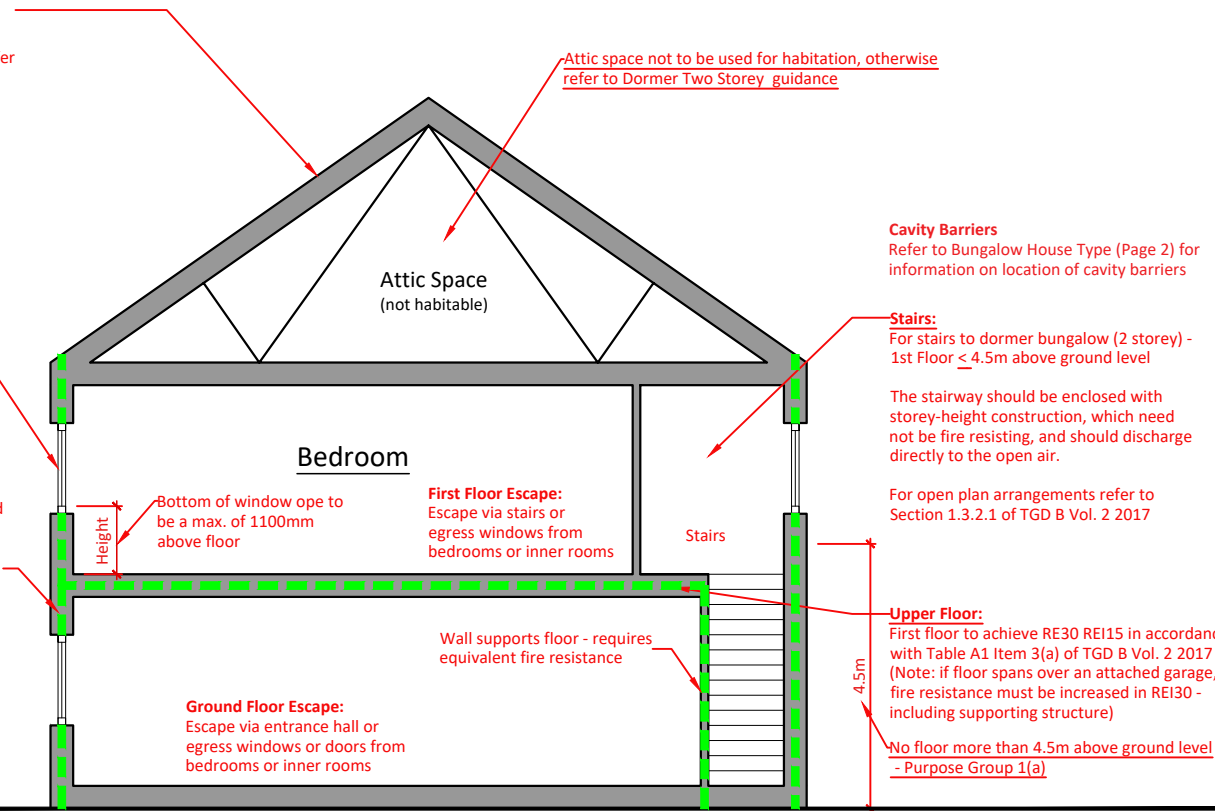

Cavity Barriers

Refer to *Bungalow House Type* (Page 2) for information on location of cavity barriers

Stairs:

For stairs to dormer bungalow (2 storey) - 1st Floor < 4.5m above ground level

The stairway should be enclosed with storey-height construction, which need not be fire resisting, and should discharge directly to the open air.

For open plan arrangements refer to Section 1.3.2.1 of TGD B Vol. 2 2017

Upper Floor:

First floor to achieve RE30 REI15 in accordance with Table A1 Item 3(a) of TGD B Vol. 2 2017 (Note: if floor spans over an attached garage, fire resistance must be increased in REI30 - including supporting structure)

No floor more than 4.5m above ground level - Purpose Group 1(a)

House Type: Two Storey

Notes:

The above guidance is not exhaustive, reference should be made to *Technical Guidance Document B (Fire Safety) Volume 2-Dwelling Houses 2017* and the *Supplementary Guidance to TGD B (Fire Safety) Volume 2 - Dwelling Houses 2017*, to ensure compliance with Part B of the Building Regulations.

Responsibility for ensuring full compliance with the Building Regulations remains with the Owner, Builder and Designer of the works. You are advised to review your design to ensure compliance with all Parts of the Building Regulations.

For Modern Methods of Construction refer to Manufacturer's Test Data and Agrément Certification to ensure compliance with Part B of Building Regulations.

Rev 1 - November 2022

Queries or comments should be referred to fireoff@tipperarycoco.ie

Key Notes: (Tick off as addressed / complete)

- Final exits in accordance with Section 1.3.9.7 of TGD B Vol. 2 2017 (thumb-turn latch)
- Escape windows in accordance with Section 1.3.7 of TGD B Vol. 2 2017
- Fire detection and alarm system - LD2 or better in accordance with IS 3218
- Cavity barriers in accordance with Section 3.6.2 of TGD B Vol. 2 2017
- Fire resistance provisions in accordance with Appendix A of TGD B Vol.2 2017:
 - External walls
 - Upper floors (if applicable)
 - Roof truss (if applicable)
 - Elements supporting fire resistant construction (if applicable)

Fire Resistance EN 1365 (series)

R - mechanical resistance i.e. an ability to maintain loadbearing capacity,
E - integrity i.e. an ability to maintain the integrity of the structure,
I - insulation i.e. an ability to provide insulation from high temperatures

- RE30 REI 15
(30 minutes fire resistance load bearing capacity and integrity, 15 minutes insulation)
- REI 30
(30 minutes fire resistance load bearing capacity, integrity and insulation)

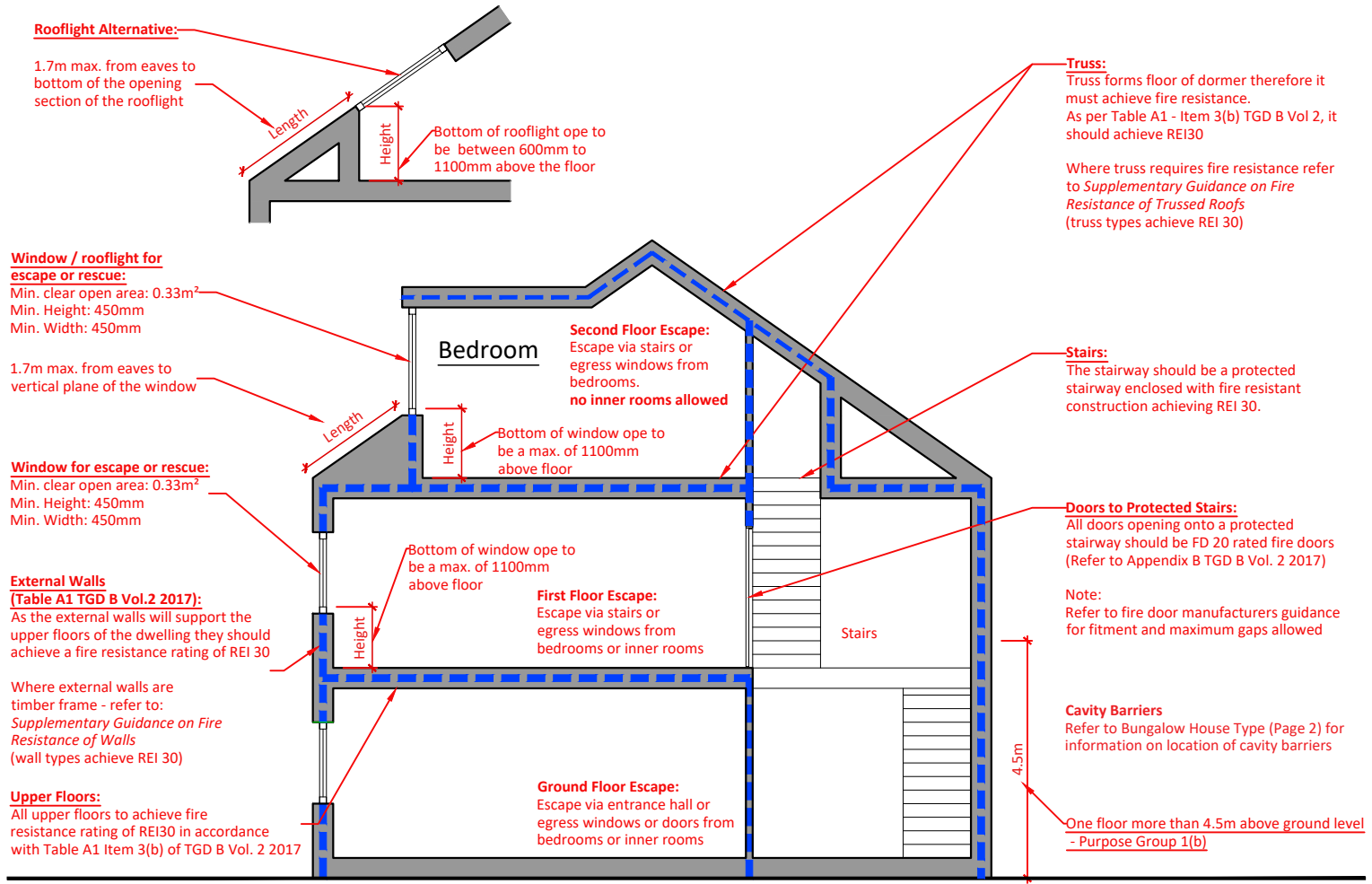

House Type: Dormer Two Storey

Notes:
 The above guidance is not exhaustive, reference should be made to *Technical Guidance Document B (Fire Safety) Volume 2-Dwelling Houses 2017* and the *Supplementary Guidance to TGD B (Fire Safety) Volume 2 - Dwelling Houses 2017*, to ensure compliance with Part B of the Building Regulations.

Responsibility for ensuring full compliance with the Building Regulations remains with the Owner, Builder and Designer of the works. You are advised to review your design to ensure compliance with all Parts of the Building Regulations.

For Modern Methods of Construction refer to Manufacturer's Test Data and Agrément Certification to ensure compliance with Part B of Building Regulations.

Rev 1 - November 2022
 Queries or comments should be referred to fireoff@tipperarycoco.ie

Key Notes: (Tick off as addressed / complete)

- Final exits in accordance with Section 1.3.9.7 of TGD B Vol. 2 2017 (thumb-turn latch)
- Escape windows in accordance with Section 1.3.7 of TGD B Vol. 2 2017
- Fire detection and alarm system - LD2 or better in accordance with IS 3218
- Cavity barriers in accordance with Section 3.6.2 of TGD B Vol. 2 2017
- Fire resistance provisions in accordance with Appendix A of TGD B Vol.2 2017:
 - External walls
 - Upper floors (if applicable)
 - Roof truss (if applicable)
 - Elements supporting fire resistant construction (if applicable)

Fire Resistance EN 1365 (series)

R - mechanical resistance i.e. an ability to maintain loadbearing capacity,
E - integrity i.e. an ability to maintain the integrity of the structure,
I - insulation i.e. an ability to provide insulation from high temperatures

- RE30 REI 15
(30 minutes fire resistance load bearing capacity and integrity, 15 minutes insulation)
- REI 30
(30 minutes fire resistance load bearing capacity, integrity and insulation)



Attic space not to be used for habitation, otherwise refer to TGD B Vol 2 2017 for 4 Storey Dwelling Guidance

Truss:
 No fire resistance required to truss if it only supports the roof, unless used as a means of escape or is essential for the stability of an external wall. (refer to Section 3.4.4 of TGD B Vol. 2 2017)

Where truss requires fire resistance refer to *Supplementary Guidance on Fire Resistance of Trussed Roofs* (truss types achieve REI 30)

Window for escape or rescue:
 Min. clear open area: 0.33m²
 Min. Height: 450mm
 Min. Width: 450mm

Upper Floors:
 All upper floors to achieve fire resistance rating of REI30 in accordance with Table A1 Item 3(b) of TGD B Vol. 2 2017

External Walls (Table A1 TGD B Vol.2 2017):
 As the external walls will support the upper floors of the dwelling they should achieve a fire resistance rating of REI 30

Where external walls are timber frame - refer to: *Supplementary Guidance on Fire Resistance of Walls* (wall types achieve REI 30)

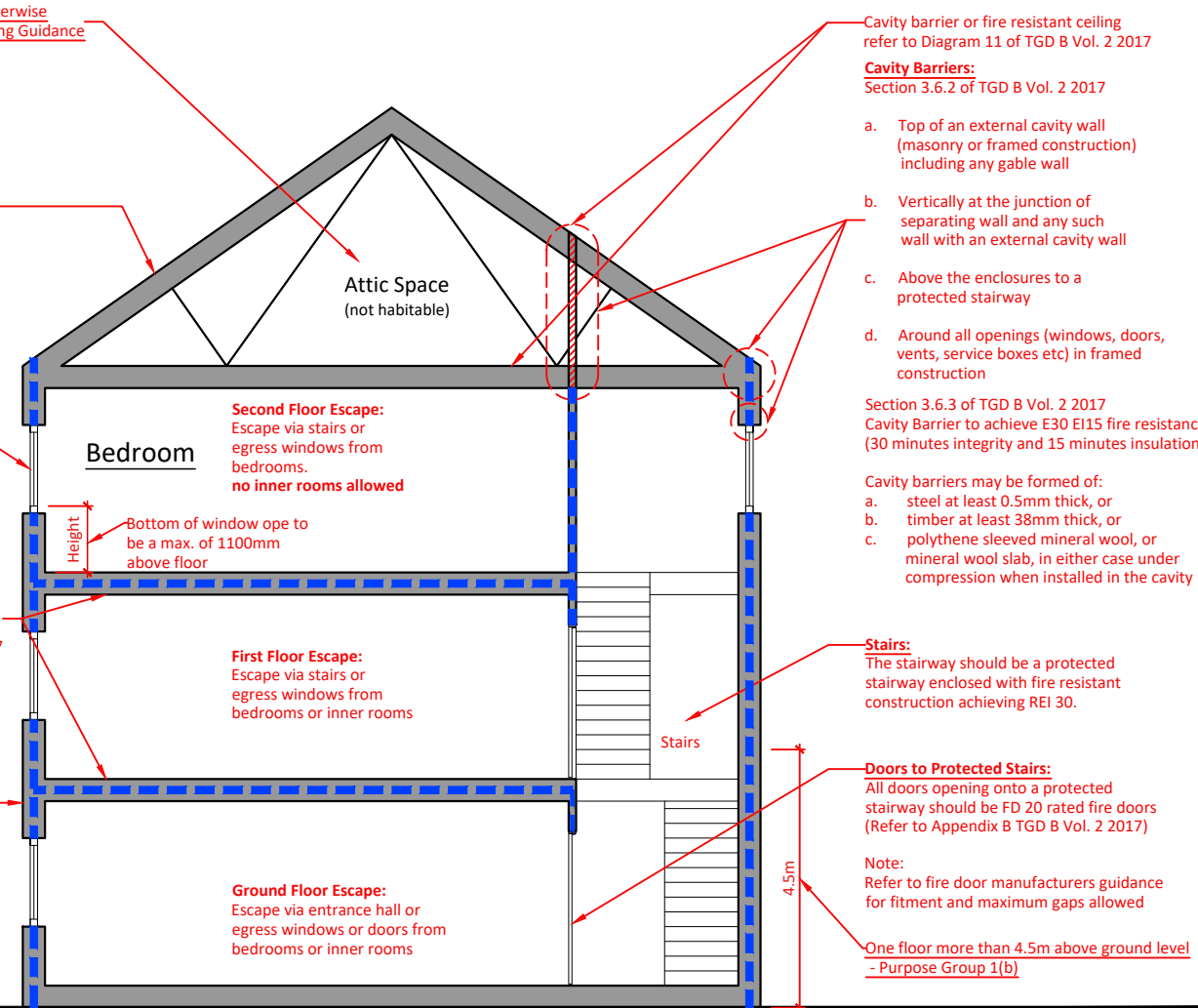

Cavity barrier or fire resistant ceiling refer to Diagram 11 of TGD B Vol. 2 2017

Cavity Barriers:
 Section 3.6.2 of TGD B Vol. 2 2017

- a. Top of an external cavity wall (masonry or framed construction) including any gable wall
- b. Vertically at the junction of separating wall and any such wall with an external cavity wall
- c. Above the enclosures to a protected stairway
- d. Around all openings (windows, doors, vents, service boxes etc) in framed construction

Section 3.6.3 of TGD B Vol. 2 2017
 Cavity Barrier to achieve E30 EI15 fire resistance (30 minutes integrity and 15 minutes insulation)

- Cavity barriers may be formed of:
- a. steel at least 0.5mm thick, or
 - b. timber at least 38mm thick, or
 - c. polythene sleeved mineral wool, or mineral wool slab, in either case under compression when installed in the cavity

Stairs:
 The stairway should be a protected stairway enclosed with fire resistant construction achieving REI 30.

Doors to Protected Stairs:
 All doors opening onto a protected stairway should be FD 20 rated fire doors (Refer to Appendix B TGD B Vol. 2 2017)

Note:
 Refer to fire door manufacturers guidance for fitment and maximum gaps allowed

One floor more than 4.5m above ground level - Purpose Group 1(b)

House Type: Three Storey

Notes:
 The above guidance is not exhaustive, reference should be made to *Technical Guidance Document B (Fire Safety) Volume 2-Dwelling Houses 2017* and the *Supplementary Guidance to TGD B (Fire Safety) Volume 2 - Dwelling Houses 2017*, to ensure compliance with Part B of the Building Regulations.

Responsibility for ensuring full compliance with the Building Regulations remains with the Owner, Builder and Designer of the works. You are advised to review your design to ensure compliance with all Parts of the Building Regulations.

For Modern Methods of Construction refer to Manufacturer's Test Data and Agrément Certification to ensure compliance with Part B of Building Regulations.

Rev 1 - November 2022
 Queries or comments should be referred to fireoff@tipperarycoco.ie

Key Notes: (Tick off as addressed / complete)

- Final exits in accordance with Section 1.3.9.7 of TGD B Vol. 2 2017 (thumb-turn latch)
- Escape windows in accordance with Section 1.3.7 of TGD B Vol. 2 2017
- Fire detection and alarm system - LD2 or better in accordance with IS 3218
- Cavity barriers in accordance with Section 3.6.2 of TGD B Vol. 2 2017
- Fire resistance provisions in accordance with Appendix A of TGD B Vol.2 2017:
 - External walls
 - Upper floors (if applicable)
 - Roof truss (if applicable)
 - Elements supporting fire resistant construction (if applicable)