

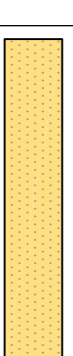

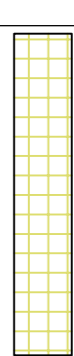



LEGEND:

Hard landscaping

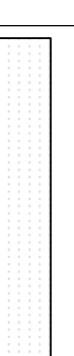
-  Carriage way surface at village junctions. Special Road Surface Coloured asphalt - buff colour
-  Repaired village centre footpath - concrete block paving, colour light grey
-  Special mosaic paving in wave shapes to symbolize river underneath. Black and white mid size granite sets to be used. High spec bedding and metal system required (Gardline or similar)
-  Heritage triangle - granite set paving laid in stagger course. Mid size granite sets, mid grey. High spec bedding and metal system required.
-  New pedestrian with tactile paving to current regulations

Street furniture

-  Proposed replacement of existing light fittings in the village centre with new light fittings. Existing utility poles to be removed and overhead wires placed underground as are existing pedestrian street lighting. New light poles.
-  2No inground uplighters under trees at heritage triangle
-  Black cast iron bollards @ 4m centres to be installed at heritage triangle Carrick St outside pub and sections of Killagh St

Soft landscaping

-  Tree planting at heritage triangle *Pyrus calleryana* 'Charlesii', 18-20cm girth, 2No
 -  Proposed planting mix for all ornamental planting areas (all 1-2ltr pots):
- | Plant Name | Quantity | Percent of area |
|--|----------|-----------------|
| <i>Philadelphus 'Marianne d'Heime'</i> | 2No | 5 |
| <i>Cornus sanguinea</i> | 3No | 10 |
| <i>Achillea millefolium</i> | 5No | 10 |
| <i>Vincetoxicum</i> (planted at periphery of circle) | 8No | 20 |
| <i>Geranium x magnificum</i> | 5No | 10 |
| <i>Geranium 'Jomson's Blue'</i> | 5No | 10 |
| <i>Geranium 'Blue Bird'</i> | 5No | 10 |
| <i>Rudbeckia 'Julius van Sullivant'</i> | 5No | 10 |
| <i>Hemerocallis minor</i> | 5No | 10 |
| <i>Iris pallida</i> 'Argentea Variegata' | 5 | 5 |

FINAL DOCUMENT
DATE: 18.09.09

Rev Date	INL	Revision
Drawn By:	RL	Date:
Scale:	@ A1	Date:
As shown	@ A1	Stage:
Checked:	RB/CW	Construction

MosArt
AGRICULTURE LANDSCAPE DESIGN

Paul & Sarah
Specialist Landscape Architects
MosArt, Co. Wick
Phone: 087 944 2177
Fax: 087 944 2176
Email: paul@mosart.ie
www.mosart.ie

Client: SOUTH TIPPERARY COUNTY COUNCIL
Job Title: DISTRICT SERVICE CENTRE ENHANCEMENT SCHEMES TIPPERARY
Drawing: Mullinahone- District Service Centre Enhancement Scheme
Job No: 400
Drawing No: 030
Revision:

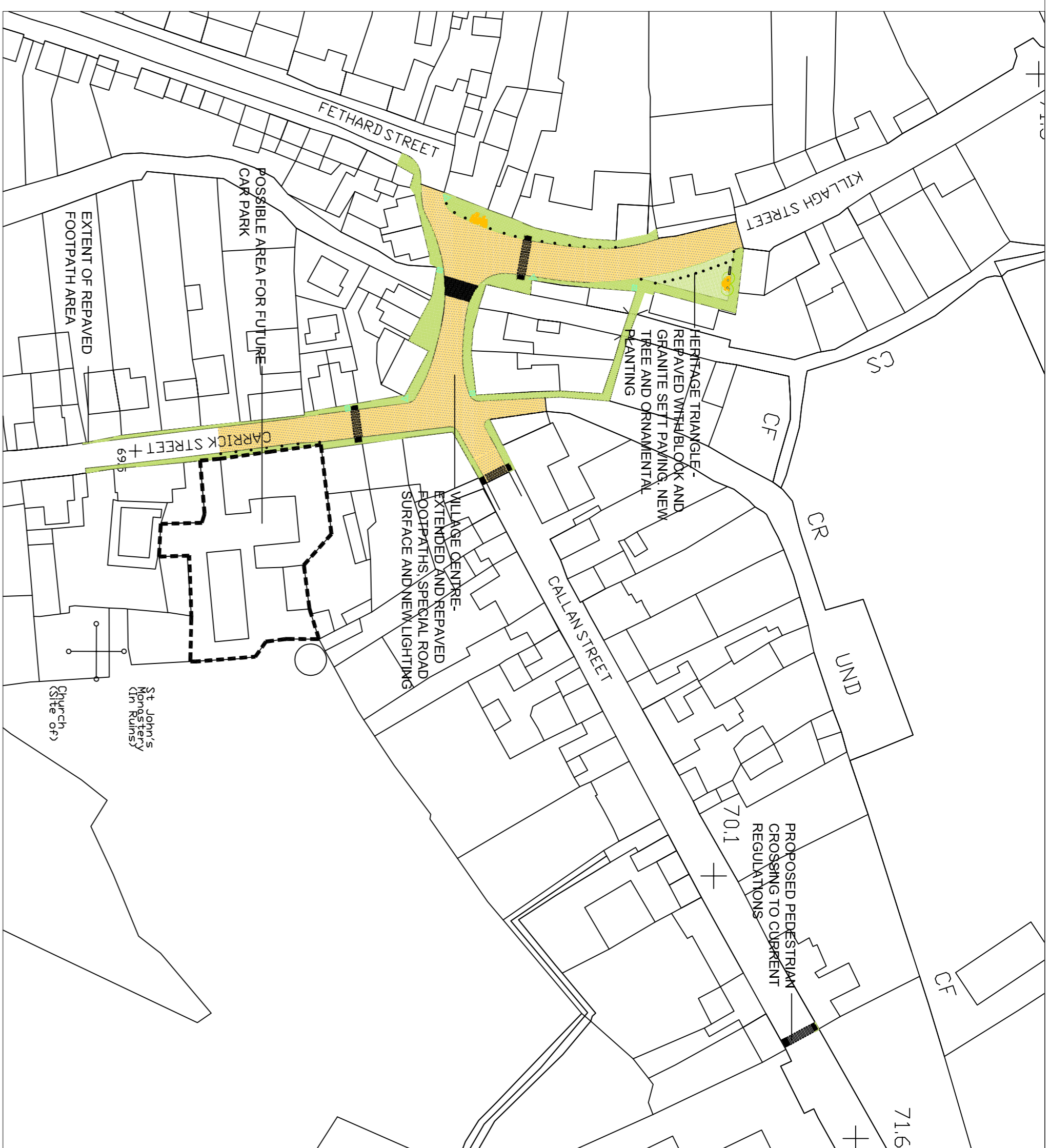

1 KEY PLAN - MULLINAHONE VILLAGE
SCALE 1:1000

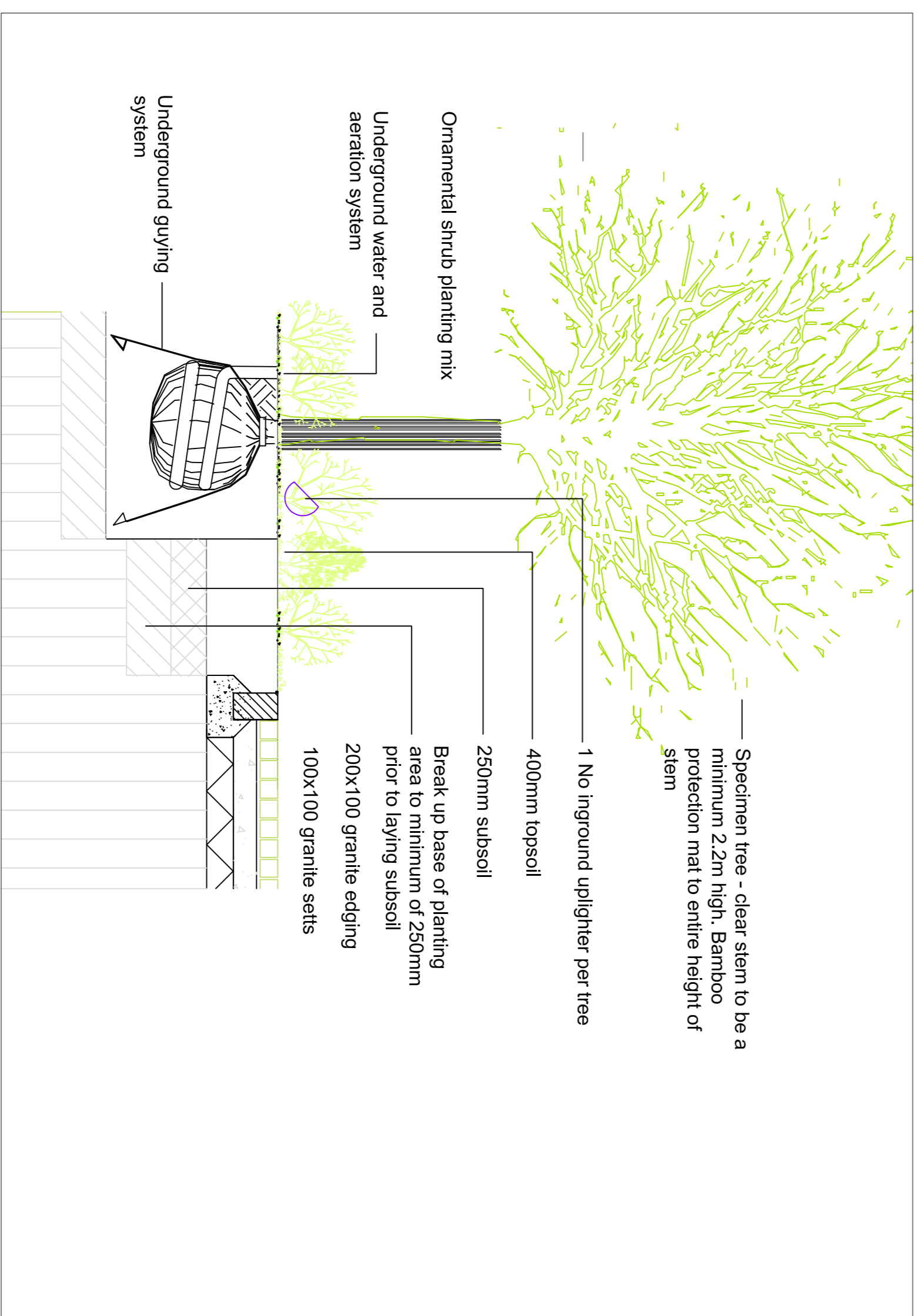

2 TREE AND ORNAMENTAL PLANTING AT HERITAGE TRIANGLE - TYPICAL SECTION
SCALE 1:25



3 VILLAGE CORE AREA
SCALE 1:500

Mullinahone- District Service Centre Enhancement Scheme

Notes:
• This drawing is indicative only. All dimensions are to be checked on site and adapted to on-site conditions and constraints.
• All materials and construction details are subject to final design and/or approval by a Project Engineer to ensure compliance with current relevant legislation.