

1 MAIN STREET - WESTERN SECTION AND VILLAGE CENTRE
050 SCALE 1:500

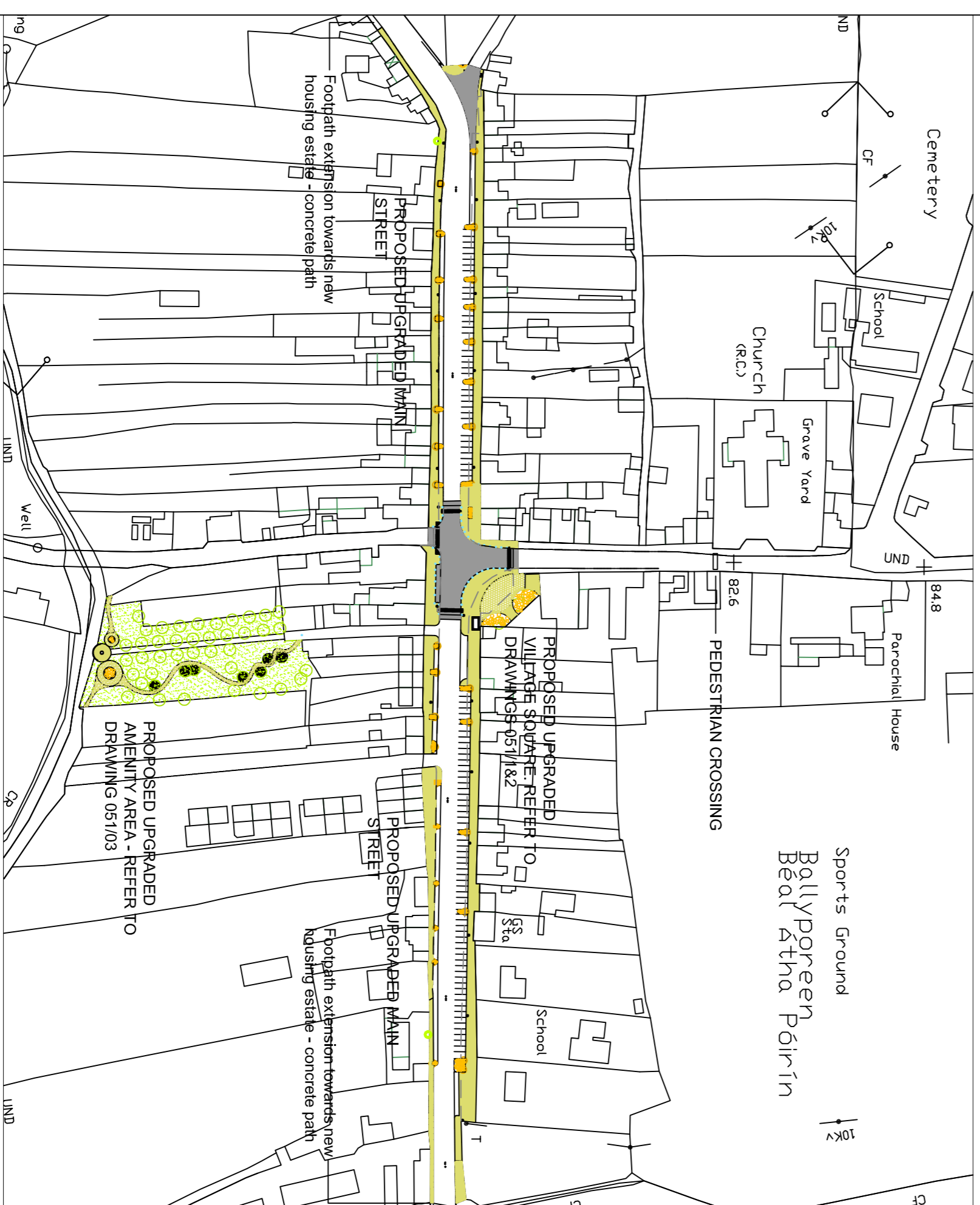

1 KEY PLAN - INCLUDING MAIN STREET AND RIVER SIDE AMENITY AREA
050 SCALE 1:2000

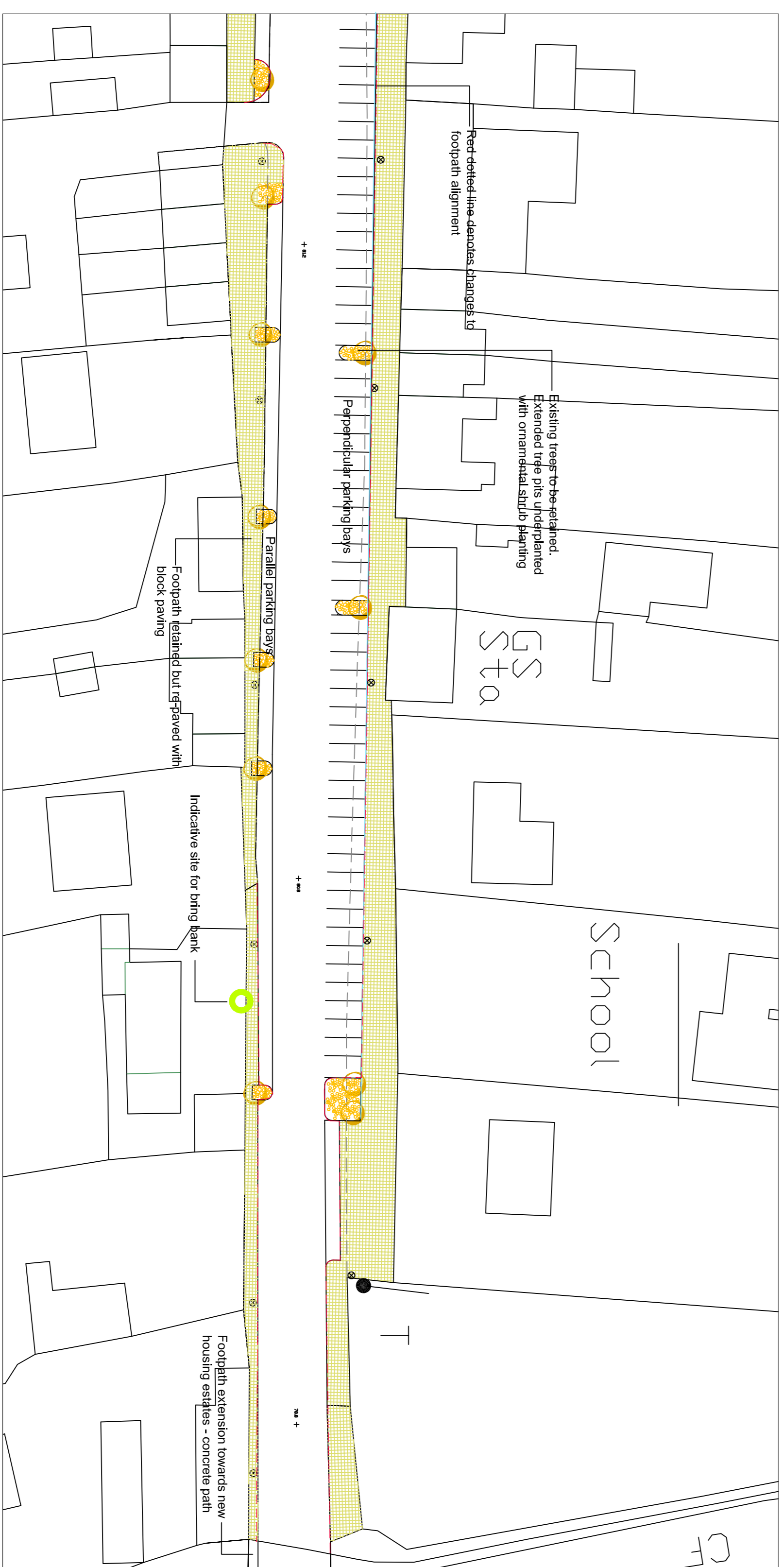

3 MAIN STREET - EASTERN SECTION
050 SCALE 1:500

LEGEND:

- Hard landscaping**
- Change way surface at village junction and western end.
 - Special Road Surface - Coloured asphalt - Surf colour
 - Repaved main street footpath - concrete block paving colour light grey
 - Village square - reconstructed granite paving flags, colour buff small white paving for ramps
 - Granite sett surround to historic weighing scales, stone granite flush with scale edges
 - New pedestrian crossing with tactile paving to orient regulations
- Street furniture**
- Proposed replacement and relocation at regular spacing of centre with new light fittings. Existing utility poles to be removed and overhead wires removed and replaced with existing pavements are replaced.
 - 6tho ground lightfitters under trees in village square planter
 - Black cast iron bollards
 - Seating incorporated into village square and outside planters

Soft landscaping

- All existing trees to be retained. Tree pits to be extended and underplanted with ornamental shrub and ground cover planting
 - Tree planting at river side amenity area - Sports sculpture planned alongside new walking path, 7No
 - Proposed planting mix for all ornamental planting areas (all 1.2m pots):
- | mm2 area (%) | Plant Name | Quantity |
|--------------|--|----------|
| 5% | Rosa gallica | SN0 20 |
| 5% | Rhododendrus 'Marianne othello' | SN0 20 |
| 5% | Camellia | SN0 20 |
| 5% | Asterilia mollis | SN 10 |
| 5% | Ceanothus 'Y magificum' | SN 10 |
| 5% | Asier 'Elfinall' 'Monsieur' | SN 5 |
| 5% | Rubuscula fulida var 'sulfurati' 'Goldlum' | SN 5 |
| 5% | Hemerocallis minor | SN 5 |
| 5% | Iris pallida 'Argentea' 'Viergegat' | SN 5 |

Final Document
DATE: 18.09.09

Rev	Date	By	Checked	As shown	Scale
1	11.08.09	RL	CW	A1	@ A1



Client: South Tipperary County Council
Job Title: District Service Centre Enhancement Schemes
Drawing: Ballyporeen - District Service Centre Enhancement Scheme - Sheet 1
Job No: 400
Drawing No: 050
Revision:

Ballyporeen - District Service Centre Enhancement Scheme - Sheet 1

- Notes:**
- This drawing is indicative only. All dimensions are to be checked on site and adapted to on-site conditions and constraints.
 - All materials and construction details are subject to final design and/or approval by a Project Engineer to ensure compliance with current relevant legislation.

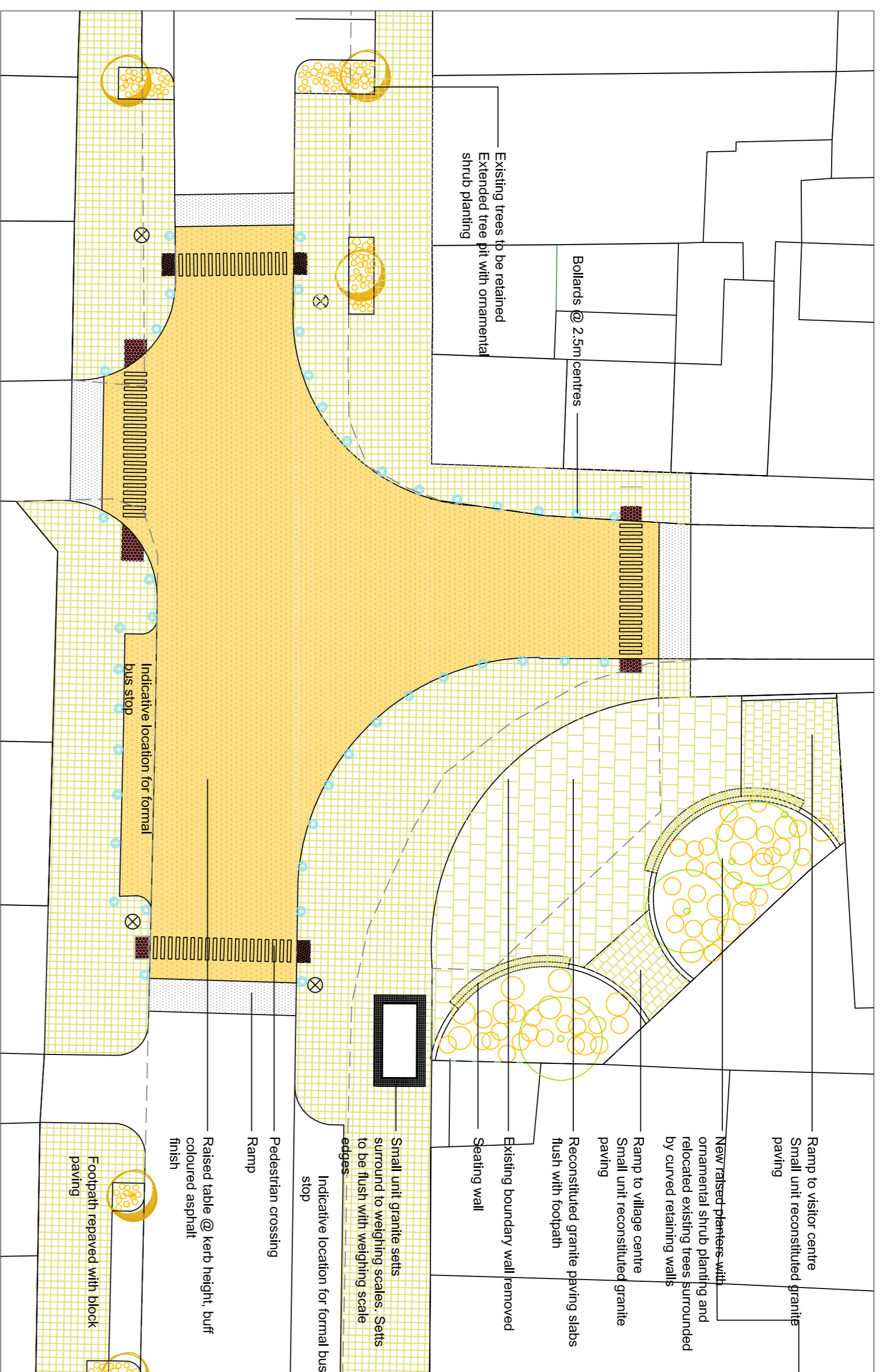

1 CENTRAL CROSSING AND VILLAGE SQUARE
051/ SCALE 1:250

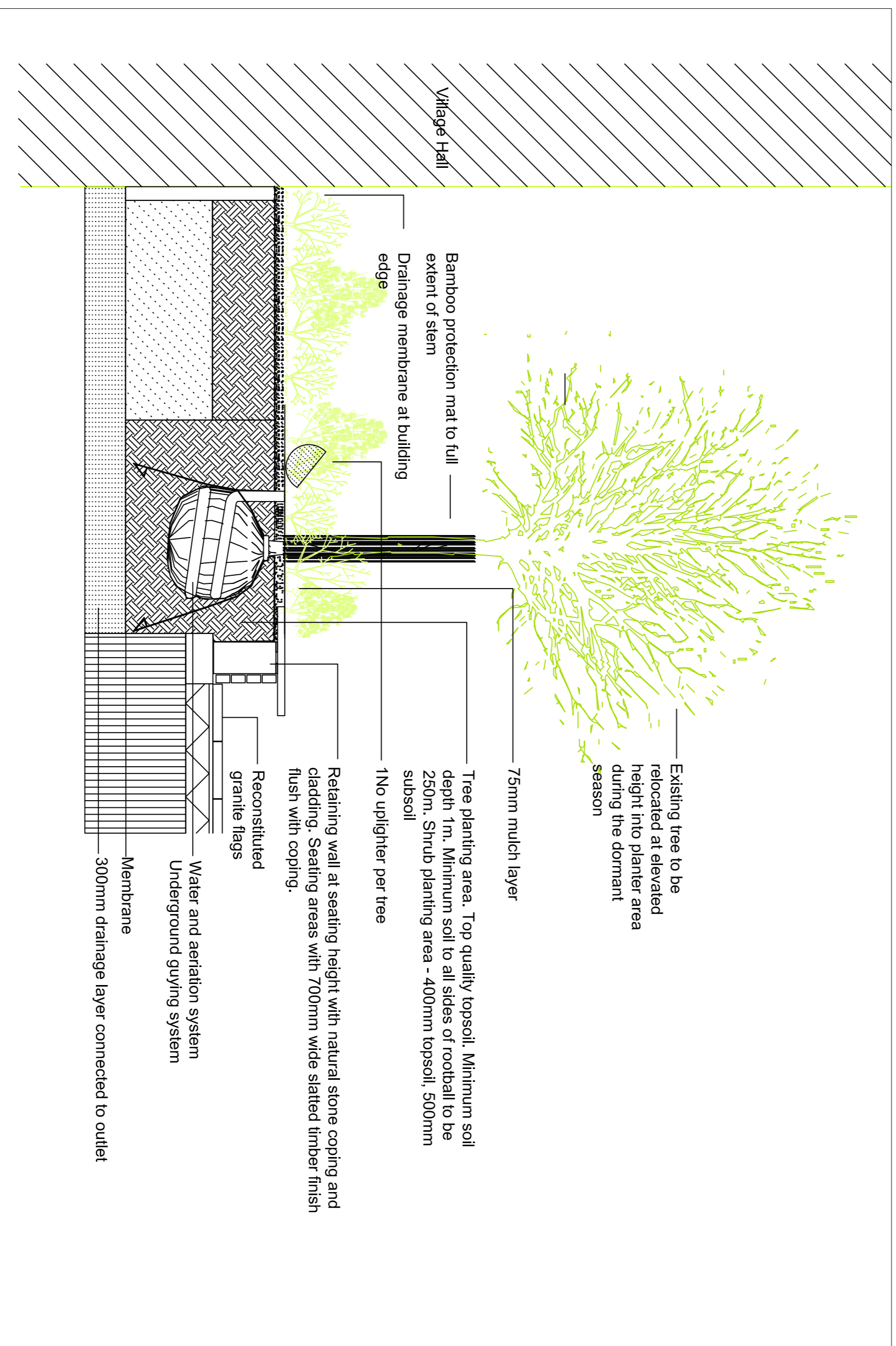

2 TYPICAL SECTION THROUGH VILLAGE SQUARE PLANTER SEATING AREA
051/ SCALE 1:25

Notes:

- This drawing is indicative only. All dimensions are to be checked on site and adapted to on-site conditions and constraints.
- All materials and construction details are subject to final design and/or approval by a the Project Engineer to ensure compliance with current relevant legislation.



3 PROPOSED UPGRADE OF RIVERSIDE AMENITY AREA
051/ SCALE 1:250

Ballyporeen - District Service Centre Enhancement Scheme - Sheet 2

LEGEND:

- Hard landscaping**
- Carriage way surface at village junction and western eng.
 - Special Road Surface - Coloured asphalt - bold colour
 - Reserved main street footpath - concrete block paving, colour light grey
 - Village square - reconstructed granite paving flags, colour buff
 - Small unit paving for ramps
 - Granite set surround to bridge weighing scales. Small granite units, mid grey. Sets to be laid flush with scale edges
 - New pedestrian crossing with tactile paving to current regulations
- Street furniture**
- Proposed replacement and relocation at regular spacing of existing light fittings in the village square with low light fittings. Existing street lighting to be removed and overhead wires placed underground where existing pavements are replaced.
 - 6No inground uplighters under trees in village square planter
 - Black cast iron bollards

Soft landscaping

- All existing trees to be retained. Tree pits to be extended and underpinned with ornamental shrub and ground cover planting
 - Tree planting at three sides of village square. Ornamental plants planted alongside new winding path, 7No
 - Proposed planting mix for all ornamental planting areas (all 1.2m pots)
- | Plant Name | Quantity | Planting Area (%) |
|----------------------------------|----------|-------------------|
| Rosa gallica | 2No | 20 |
| Prunella vulgaris | 2No | 20 |
| Cornus sanguinea | 2No | 20 |
| Geranium 'nanus' | 2No | 10 |
| Geranium 'Johnson's Blue' | 2No | 10 |
| Aster 'Freckled Wizard' | 2No | 5 |
| Hydrangea 'Annabelle' | 2No | 5 |
| Heriaca 'Aurea' | 2No | 5 |
| Tris patula 'Argentea Variegata' | 2No | 5 |

FINAL DOCUMENT
DATE: 18.09.09

Rev	Date	By	Checkd	Scale	As shown
N/L	11.08.09	RL	CW	@ A1	Construction

MOSART

ARCHITECTURE LANDSCAPE URBAN DESIGN

300A E
Bandon Ballee Pk,
Bandon, Co. Wick,
Ireland
Tel: +353 (0) 46 27 77
Fax: +353 (0) 46 24 24
Email: info@mosart.ie
www.mosart.ie

Client: South Tipperary County Council

Job Title: District Service Centre Enhancement Schemes
Tipperary

Drawing: Ballyporeen - District Service Centre Enhancement Scheme - Sheet 2

Job No: 400

Drawing No: 051

Revision: